

Alco-Breath Tube



REF

103-ABT-08
103-ABT-15

Intended Use

The Alco-Breath tube test is intended to detect the presence of alcohol in the breath at concentrations between 0.02 BrAC (Breath Alcohol Concentration) and 0.08 or 0.15 BrAC. The Alco-Breath Tube is intended for screening in medical and therapeutic programs. This product will also give a semi quantitative estimate of alcohol levels in these ranges. The Alco-Breath tube is a disposable device designed for one-time use.

Limitations on Use

The Alco-Breath tube gives preliminary screening test results. Test results obtained with the Alco-Breath tube are not intended to be used as evidential results.

Principle of Operation

The Alco-Breath tube uses a length-of-stain method to give estimates of alcohol concentrations. Silica gel is treated with a reagent containing potassium dichromate that gives the silica gel a distinctive yellow color. The reagent-treated gel is packed into a glass tube. When the reagent-treated silica gel is exposed to breath alcohol that is passed through the tube, the alcohol in the breath creates a chemical reaction that changes the yellow color to a green color. The green color moves progressively up the length of the tube proportional to the amount of alcohol in the breath. The device is read at the upper level of the color change using a scale on the tube, much like reading a thermometer.

Performance Characteristics

Reagent-treated silica gel:

- The reagent-treated silica gel is yellow in color before reaction with alcohol.
- When exposed to alcohol between the ranges of 0.02 and 0.08 BrAC or 0.02 and 0.15 BrAC, the selected device will give a reading within +/- 0.02 BrAC.
- The color change caused by exposure to alcohol will remain for several months in the condition at the time of reading the test. Except that a reading of .12 or higher may continue to react after the time of reading the test to show a higher reading.

- When exposed to a breath sample with no alcohol, the reagent-treated silica gel color will be unchanged.
- The test device will react to alcohol for 18 months.
- The moisture indicating gel will have a medium to dark blue color when dry and not exposed to humidity. When exposed to environmental humidity, the blue color will fade away to a very light blue. At higher exposure to humidity, a pink color will appear.
- The test device will have a resistance to air passing through it such that it will take at least one minute for the air from a fully inflated balloon attached to the test device to completely deflate.
- The balloon used is of a size and resistance that a person can fully inflate the balloon with two or three deep breaths (approximately 1.5 liters).



Instructions for Use of Alco-Breath tube Breath Alcohol Test

- Wait 15 minutes after the last alcohol beverage, or drink 10 ounces of water before use.

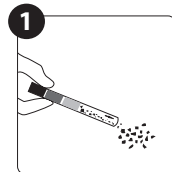

Remove caps and empty blue crystals from both ends of the tube.

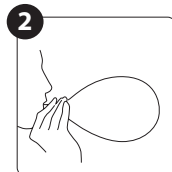

Instruct subject to fully inflate the balloon with deep continuous breaths.

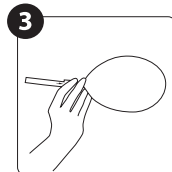

Pinch the neck of the inflated balloon so air does not escape and insert the end of the tube into the balloon mouthpiece.

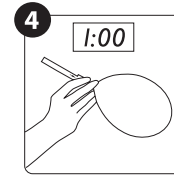

Allow the breath from the balloon to pass through the tube for ONE MINUTE. Remove the balloon.

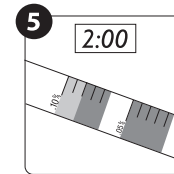

Wait TWO minutes before viewing the results. Yellow crystals in the tube will change to green if alcohol is present.

- Read the test result at the highest level of color change using the % scale on the test much like reading a thermometer.
- ABT-15 product will display results from 0.02 BrAC to 0.15 BrAC
- ABT-08 product will display results from 0.02 BrAC to 0.08 BrAC



Cautions

- Do not use the Alco-Breath tube test device after the expiration date printed on the packaging material.
- Keep the test devices out of the reach of children.
- Do not ingest the reagent-treated silica gel. If ingested, induce vomiting and contact your physician.
- Do not immerse the test device in water.

AlcoPro, Inc.

PO Box 10954
Knoxville, TN 37939
USA
+1 865-25-4900



CEpartner4U
3951 DB, 13.NL
Tel: +31 (0) 6-516-536-26